

100
0 10
Millimetres
DO NOT SCALE

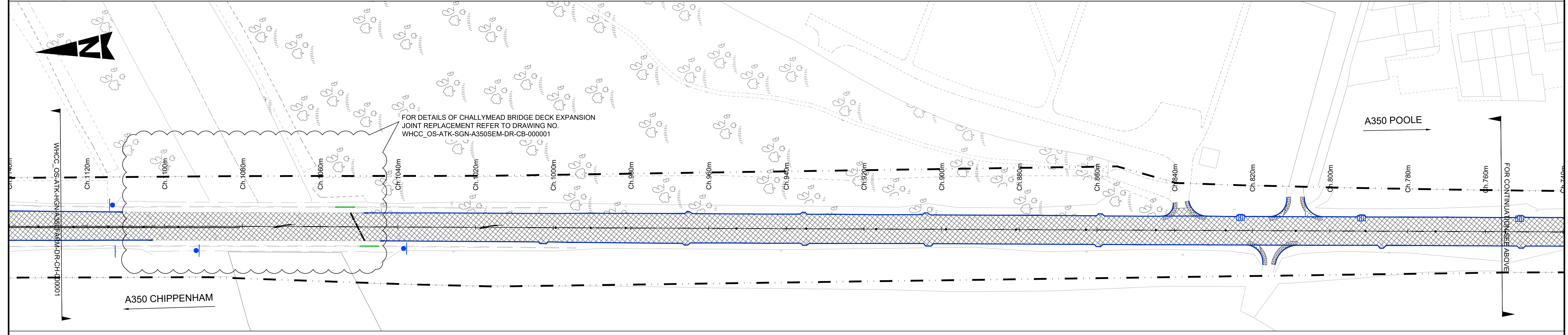
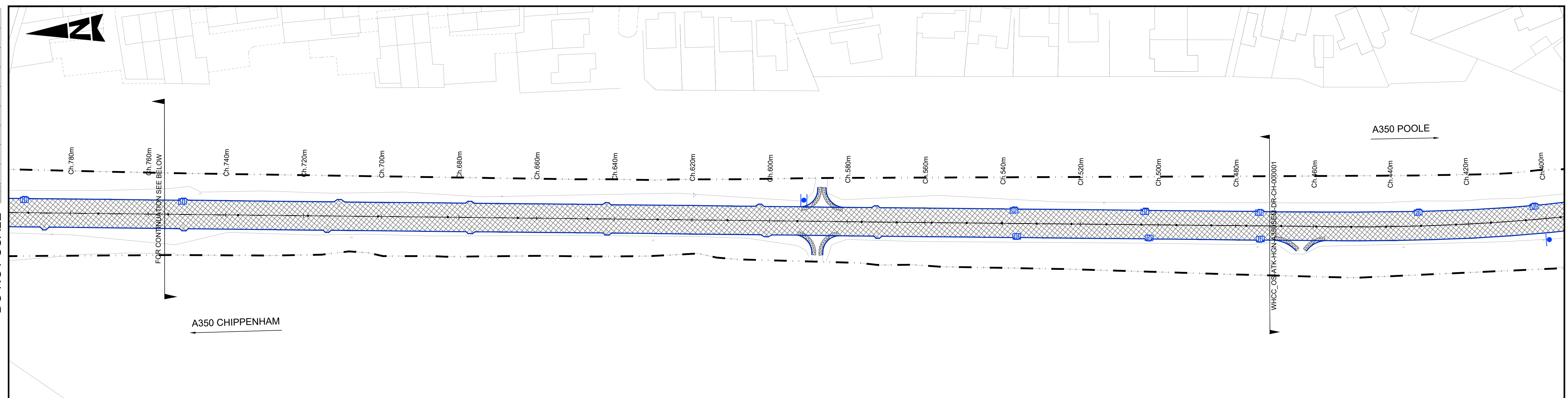

- NOTES**
- DO NOT SCALE FROM THIS DRAWING.
 - ALL DIMENSIONS ARE IN METRES UNLESS OTHERWISE STATED.
 - LIMITS OF WORK ARE APPROXIMATE AND TO BE AGREED ON SITE WITH OVERSEEING ORGANISATION.
 - FOR PROPOSED SIGNS REFER TO DRAWINGS NO. WHCC_OS-ATK-HSN-A350SEM-DR-CH-000002.
 - FOR PROPOSED ROAD MARKING REFER TO DRAWING NO. WHCC_OS-ATK-HMK-A350SEM-DR-CH-000002.
 - FOR PROPOSED KERB, FOOTWAY AND PAVED AREA REFER TO DRAWING NO. WHCC_OS-ATK-HKF-A350SEM-DR-CH-000002.
 - FOR PROPOSED PAVEMENT LAYOUT PLAN REFER TO DRAWING NO. WHCC_OS-ATK-HPV-A350SEM-DR-CH-000002.
 - FOR PROPOSED EARTHWORK REFER TO DRAWING NO. WHCC_OS-ATK-HGT-A350SEM-DR-CH-000002.
 - CONTRACTOR TO CHECK AND CONFIRM THAT GULLY CONNECTIONS FOR EXISTING RETAINED GULLIES EXIST AND ARE UNDER GOOD CONDITION. CONTRACTOR TO REPAIR ANY DEFECTIVE CONNECTION OR ESTABLISH A NEW CONNECTION WHERE ABSENT.

THIS MAP IS REPRODUCED FROM ORDNANCE SURVEY MATERIAL WITH THE PERMISSION OF ORDNANCE SURVEY ON BEHALF OF THE CONTROLLER OF HER MAJESTY'S STATIONERY OFFICE. © CROWN COPYRIGHT. UNAUTHORISED REPRODUCTION INFRINGES CROWN COPYRIGHT AND MAY LEAD TO PROSECUTION OR CIVIL PROCEEDINGS. 100049050, 2018

KEY

	HIGHWAY BOUNDARY
	EXISTING KERB TO BE REPLACED WITH PROPOSED KERB (SEE NOTE 6)
	EXISTING PAVED AREA TO BE OVERLAID / INLAID / PLANED OUT (SEE NOTE 7)
	PROPOSED CARRIAGEWAY WIDENING / NEW CONSTRUCTION (SEE NOTE 7)
	PROPOSED EDGE CONSTRUCTION TIE -IN BETWEEN NEW AND EXISTING CARRIAGEWAY (SEE NOTE 7)
	PROPOSED TRAFFIC SIGN (SEE NOTE 4)
	EXISTING CHALLYMEAD BRIDGE DECK EXPANSION JOINT TO BE REINSTATED WITH NEW EXPANSION JOINT
	TEMPORARY REMOVAL AND REINSTALLATIONS OF EXISTING JERSEY BARRIER UNITS (REFER APPENDIX 2300 SERIES FOR DETAILS)
	TO REPAIR ANY DEFECTIVE CONNECTION OR TO ESTABLISH A NEW CONNECTION FOR EXISTING GULLY (SEE NOTE 9)

SAFETY, HEALTH AND ENVIRONMENTAL INFORMATION							
Description							
Status	Revision	Drawn	Checked	Reviewed	Authorised	Issue Date	
Description							
Construction							
Live traffic, live utilities							
Description							
Maintenance / Cleaning							
None							
Description							
Use							
None							
Description							
First Issue							
Status	Revision	Drawn	Checked	Reviewed	Authorised	Issue Date	
S3	P01	TJ	KS	SD	---	20/06/18	
Description							
For Review							
Status	Revision	Drawn	Checked	Reviewed	Authorised	Issue Date	
A1	C01	TJ	KS	SD	MM	24/07/18	

Drawing Suitability	APPROVED - PUBLISHED	Status	A1	Project Title	A350 Farmers Signallisation and Semington Improvements		
				County Gate County Way Trowbridge Wiltshire BA14 7FJ Tel: +44 (0)1225 730360			
Copyright © Atkins Limited (2018) www.atkinsglobal.com				Client			
				Drawing Number Project WHCC_OS - ATK - HGN - A350SEM - DR - CH - 000002			
Original Size: A1				Scale: 1:500		Project Ref. No: 5161392	
				Sheet: 2 of 2		Rev: C01	