

100
Millimetres
0 10
DO NOT SCALE

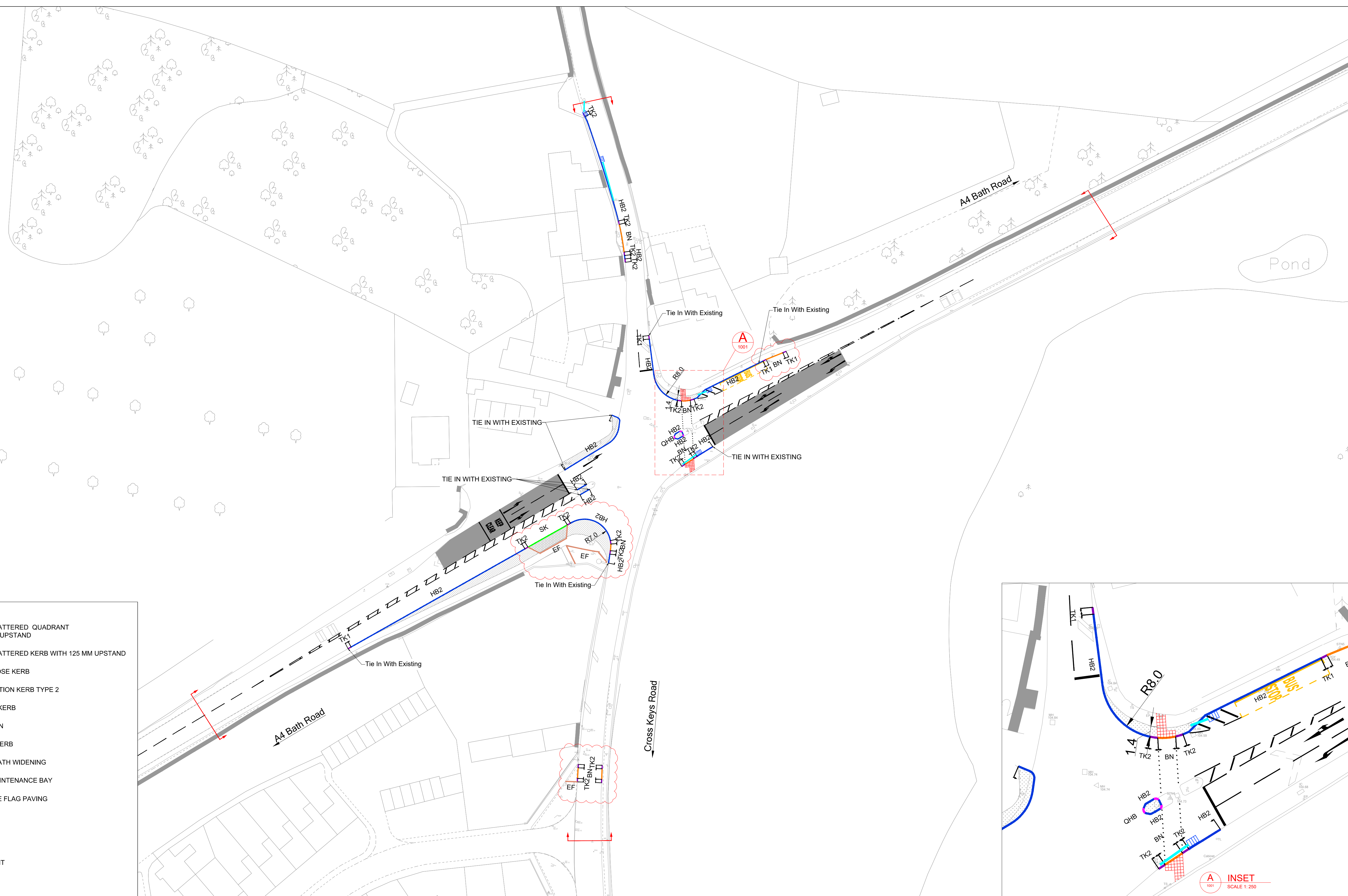

KEY

	PROPOSED HALF BATTERED QUADRANT KERB WITH 125 MM UPSTAND
	PROPOSED HALF BATTERED KERB WITH 125 MM UPSTAND
	PROPOSED BULLNOSE KERB
	PROPOSED TRANSITION KERB TYPE 2
	PROPOSED SPLAY KERB
	GULLY CONNECTION
	PROPOSED EDGE KERB
	PROPOSED FOOTPATH WIDENING
	TRAFFIC SIGNAL MAINTENANCE BAY
	PROPOSED TACTILE FLAG PAVING
	PROPOSED GULLY
	SITE EXTENTS
	DESIGN AMENDMENT

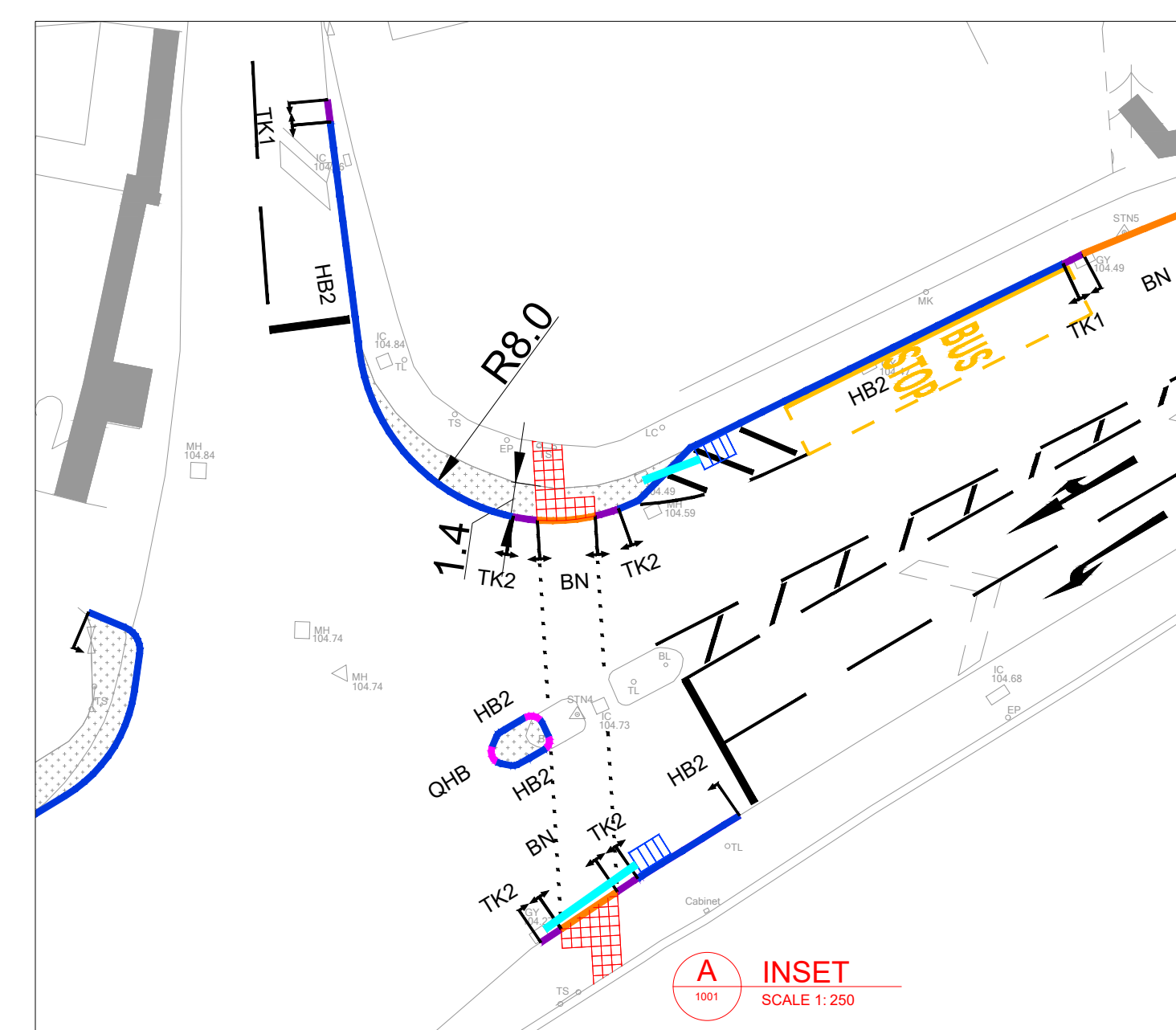

SAFETY, HEALTH AND ENVIRONMENTAL INFORMATION

In addition to the hazards/risks normally associated with the types of work detailed on this drawing, note the following significant residual risks (Reference shall also be made to the design hazard log).
Construction None
Maintenance / Cleaning None
Use None
Decommissioning / Demolition None

NOTES

- DO NOT SCALE FROM THIS DRAWING.
- ALL DIMENSIONS ARE IN METRES UNLESS OTHERWISE STATED.

P02	SL	RJ	KB	29.05.2018
Second Issue				
P01	KM/SG	RJ	SS	22.12.2017
First Issue				
Rev	Drawn / Des	Checked	Approved	Date
Description				

Drawing Status: **WORK IN PROGRESS**

ATKINS

County Gate, County Way
Trowbridge, Wiltshire England
BA14 7FJ
United Kingdom

Tel: +44 (0)1225 730360
Fax: +44 (0)
www.atkinsglobal.com

Copyright © Atkins Limited (2015)

Client: **Wiltshire Council**
Where everybody matters

Suitability	S0	Project Title	A4 Bath Road / Cross Keys Road, Corsham						
Drawing Title	GENERAL ARRANGEMENT								
Scale	1:500	Designed / Drawn	SG/KM	Checked	RJ	Approved	SS	Authorised	KB
Original Size	A1	Date	22.12.2017	Date	22.12.2017	Date	22.12.2017	Date	29.05.2018
Drawing Number	Project		Originator	Volume	Job No.		5159105		
5159105 - ATK - HGN -		0100 - DR - D - 1001		P02		Revision			
Location	Type	Role	Number						

Plotted: May 24, 2019 - 10:10am by: LATAY335