

Biss Meadows

9.12 Biss Meadows

Location

9.12.1 Biss Meadows lies to the south of County Way with housing to the north-east and Tesco to the south-west

Access and Permeability

9.12.2 The back of the housing and the Tesco store provides only limit access to Biss Meadows to the footpath connections at either end.

Area Specific Opportunities

9.12.3 Biss Meadows is currently well-used by members of the public and offers informal amenity space.

9.12.4 Proposals for Biss Meadows should aim to reinforce the informal country park character. The area currently benefits from a footpath and cycleway along its length.

9.12.5 The central and southern part of Biss Meadows is a valuable wildlife asset for the area. The management of the area should promote biodiversity through appropriate river and wetland habitat enhancements.

9.12.6 Biss Meadow is also an important educational resource and there are significant opportunities for interpretation and access improvements. The construction of a boardwalk in this area should improve access for all users.

Ecology

9.12.7 Proposals for river restoration are concentrated in this central section adjacent to the proposed boardwalk. Ecological improvements are focussed on the creation of marginal planting shelves and works to the large weir to reduce impounding effect on the upstream section of river.

9.12.8 The existing pond in the centre of Biss Meadows is succeeding into wet woodland/scrub and forming a valuable habitat. To compensate for this loss of wetland habitat, a series of new ponds are proposed in the south of the site.

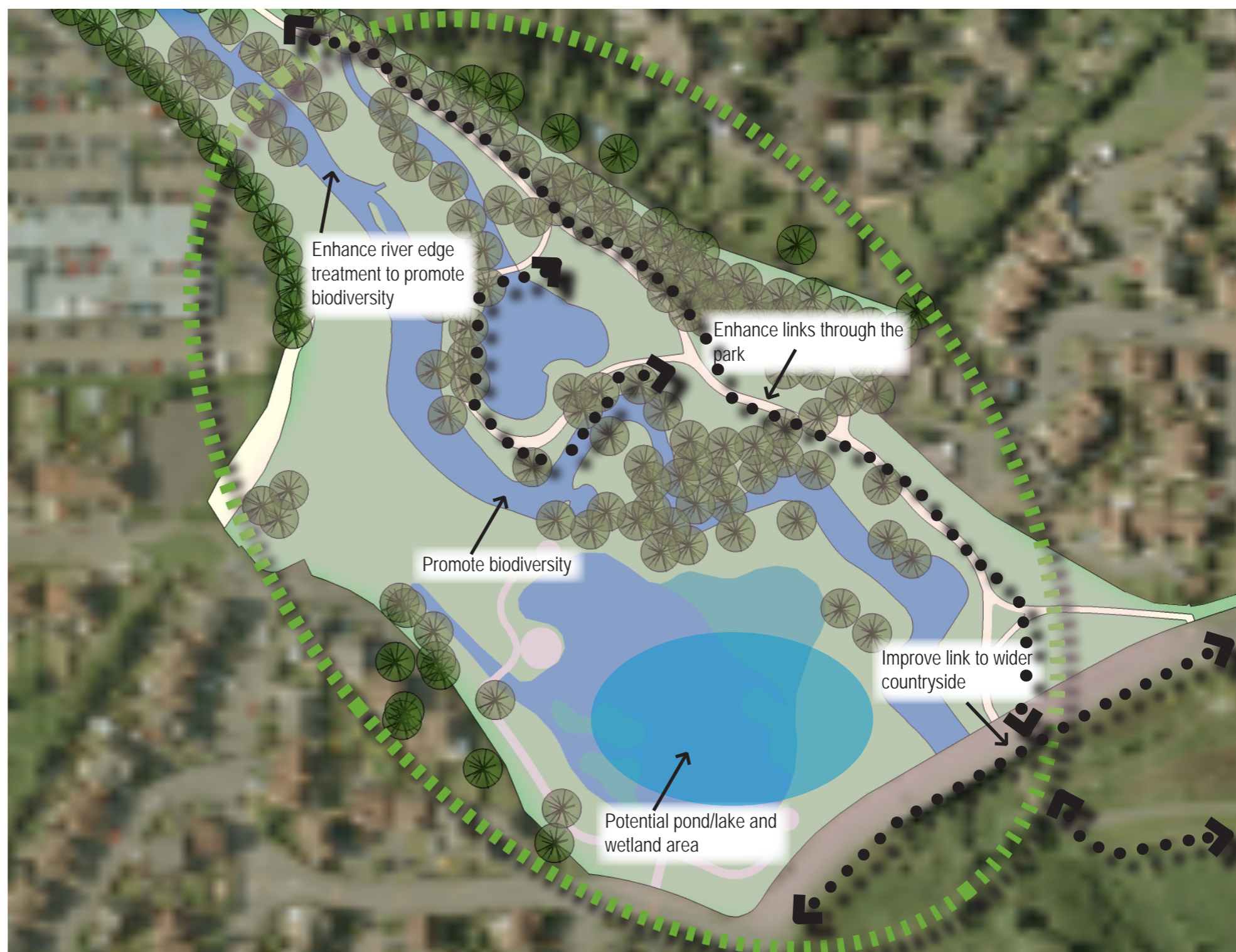

Figure 9.16: Biss Meadows opportunities.

Biss Meadows

9.12.9 There is potential to extend the existing wetland by creating a new pond or series of smaller ponds and ‘scrapes’, which would bring ecological, amenity and educational benefits. The pond(s) should be designed with a varied edge treatment in order to provide a range of habitats. Access to the pond(s) should be defined on the south western side through the provision of new footpaths and timber decking. By limiting access to the western side of the pond, the aim is to reduce disturbance on the eastern side and allow a lower intervention management regime to encourage biodiversity (creation of a ‘wildlife refuge’).

Design Checklist

9.12.10 New development in this area should:-

- seek the opportunity to redesign the formal pond and channel in the People’s Park, to create a more natural profile with improved access for amenity and educational purposes;
- have new planting that reflects the semi-natural character continued in Biss Meadows Country Park;
- seek the opportunity for street furniture items in conjunction with the cycle route;
- have lighting which respects the close proximity to housing and the naturalistic character of this area;
- have signage to promote the cycle route and town centre activities;
- seek the opportunity to remove the engineered structures along the channel in the People’s Park in order to improve access and enhance the ecology of the area.



Figure 9.17: Biss Meadows illustrative public realm proposals.

Biss Meadows



3d image of character area.



Figure 9.18: Biss Meadows illustrative public realm proposals.