

# Appendix D – Transport Drawings & Layouts



## D.3 South Wiltshire

### D.3.1 Harnham Business Park, Salisbury (Site Ref S3) Site Assessment



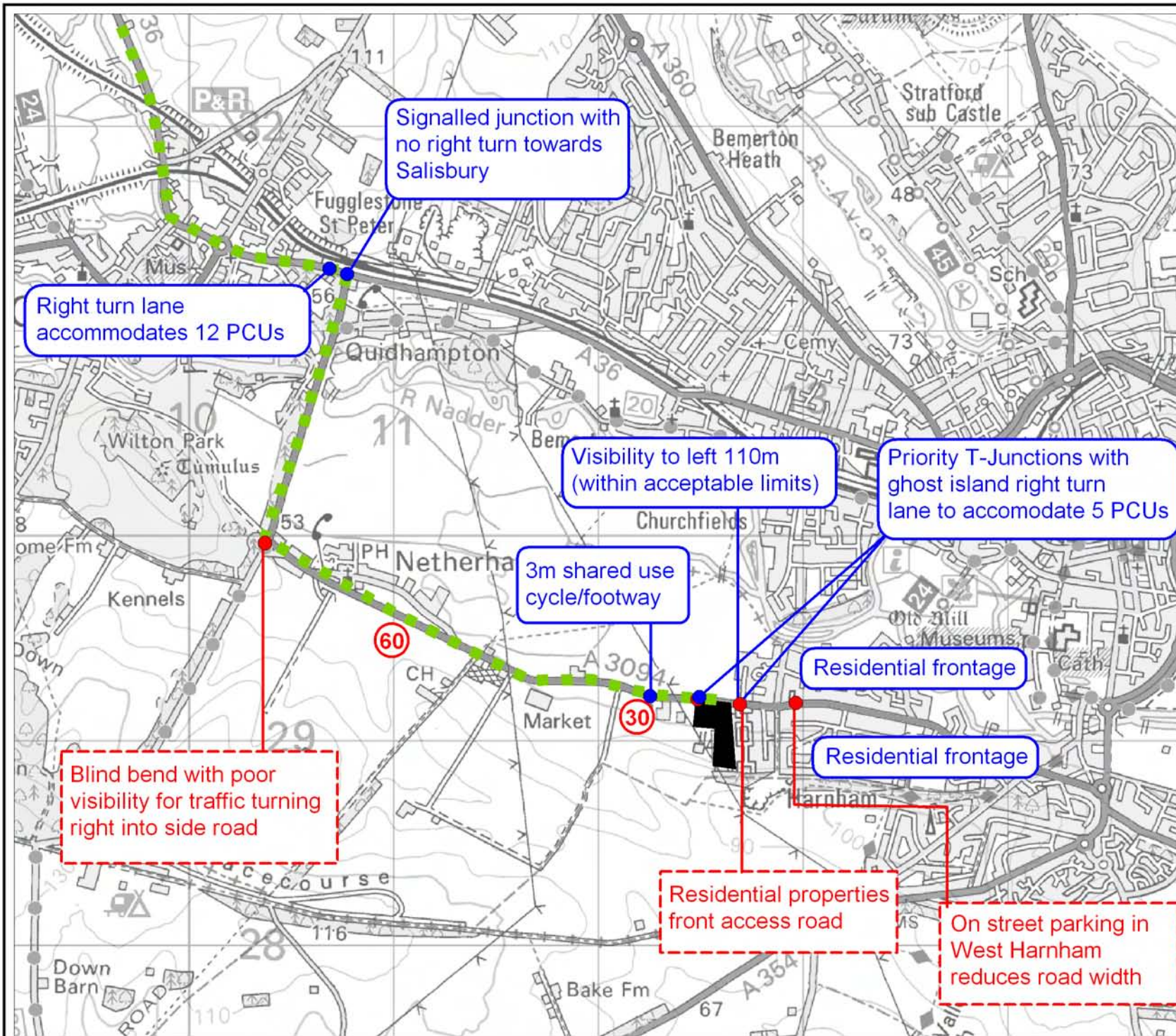

### Key

- Site
- Information
- Constraint
- Recommended access to strategic HGV network
- 40 Speed limit

Project:  
 Wiltshire and Swindon Waste Site Allocations DPD: Detailed Site Assessments

Drawing Title:  
 S3 - Harnham Business Park, Salisbury

Drawing No:  
 5044619.017/TP/S3/001



© Crown copyright 2010. All rights reserved.  
 Licence number 0100049050



**D.3.2 Maidment Skip Hire, Swallowcliffe (Site Ref S4)  
Site Assessment**





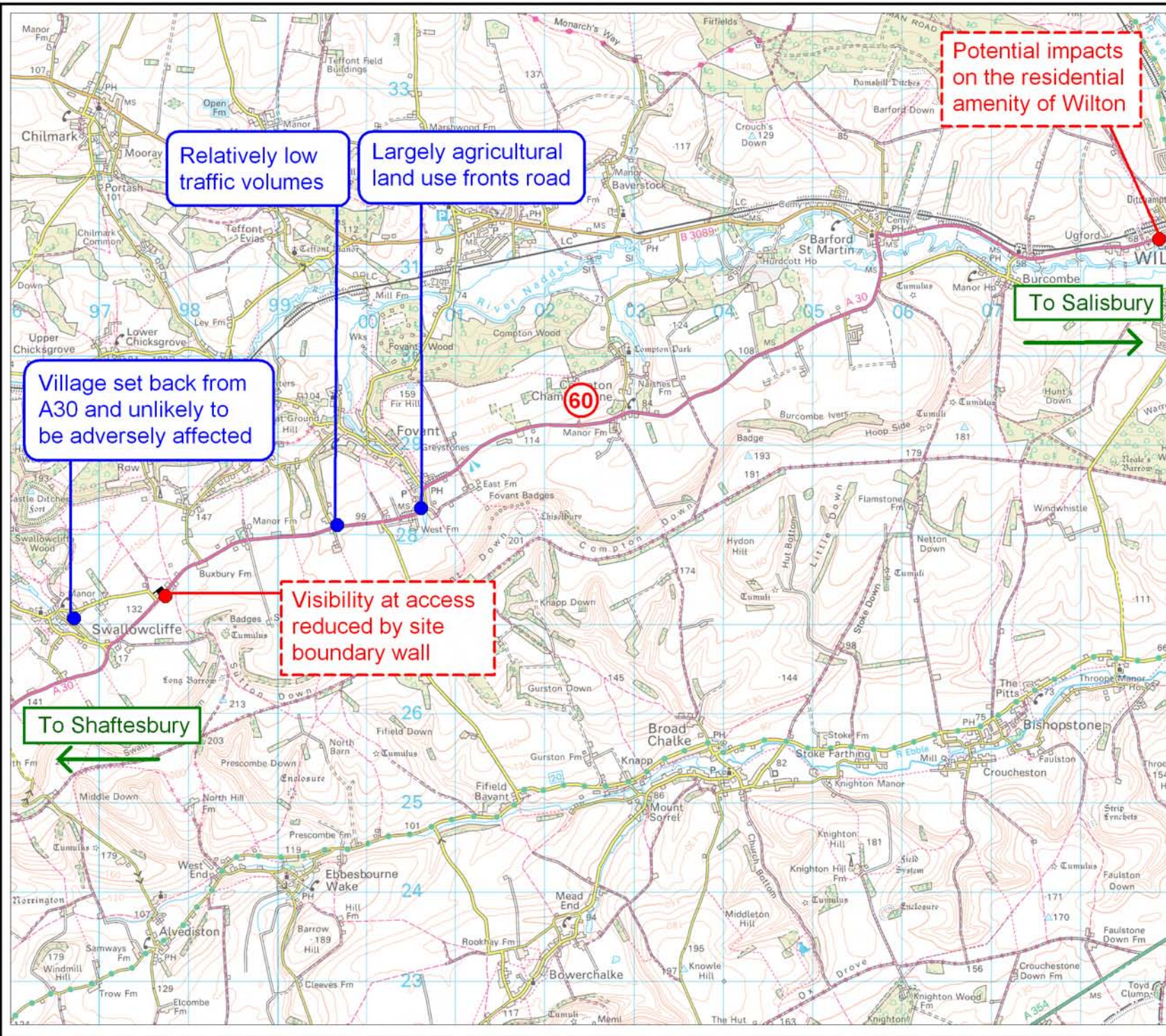

**Key**

- Site
- Information
- Constraint
- ⓪ 40 Speed limit

Project:  
 Wiltshire and Swindon Waste Site Allocations DPD: Detailed Site Assessments

Drawing Title:  
 S4 - Maidments Skip Hire, Swallowcliffe

Drawing No:  
 5044619.017/TP/S4/001





**D.3.3 Sarum Business Park, Salisbury (Site Ref S5)  
Site Assessment**



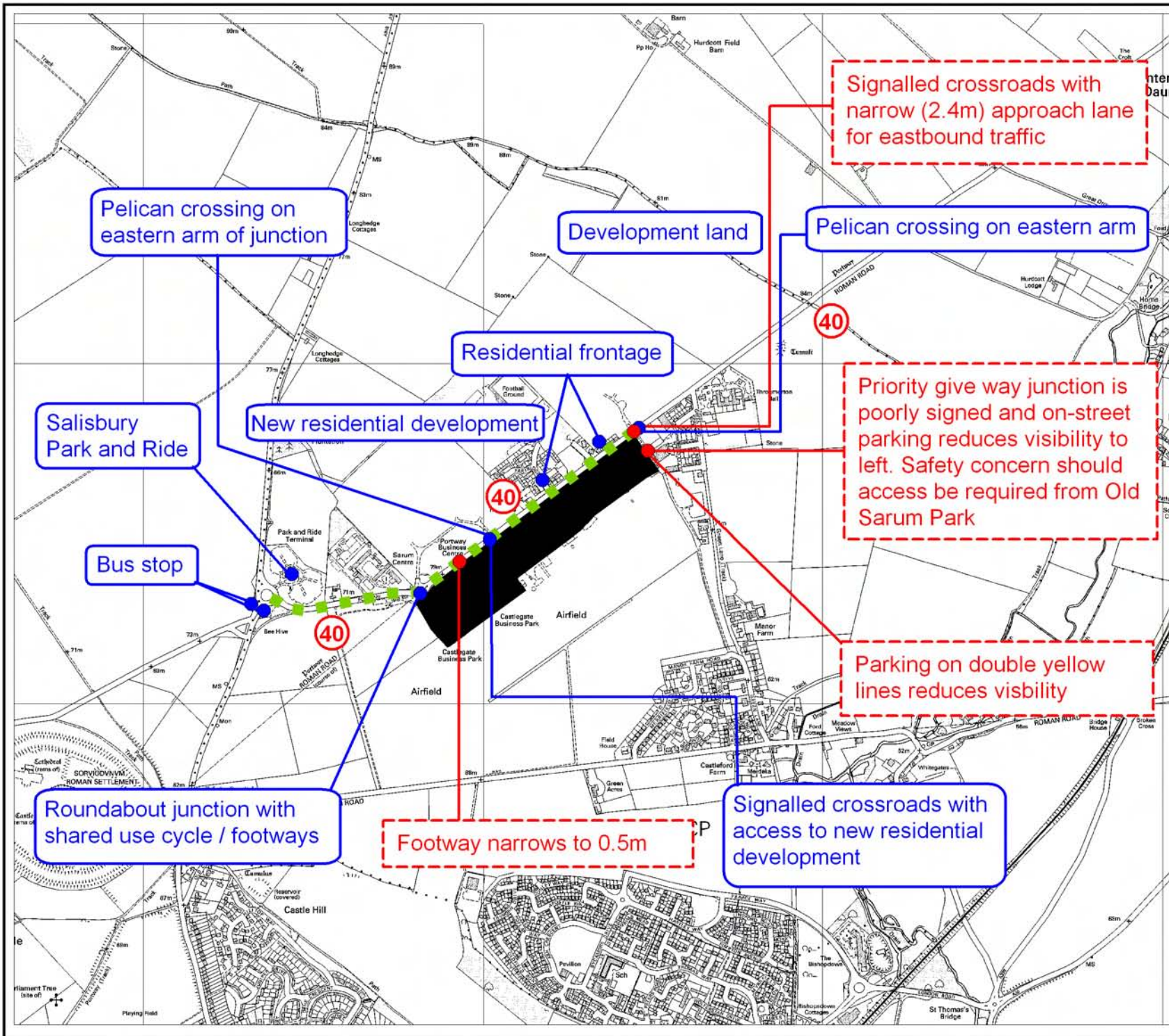

### Key

- Site
- Information
- Constraint
- Recommended access to strategic HGV network
- 40 Speed limit

Project:  
 Wiltshire and Swindon Waste Site Allocations DPD: Detailed Site Assessments

Drawing Title:  
 S5 - Sarum Business Centre, Salisbury

Drawing No:  
 5044619.017/TP/S5/001



© Crown copyright 2010. All rights reserved.  
 Licence number 0100049050



**D.3.4 Salisbury Road Industrial Estate, Downton (Site Ref S7)  
Site Assessment**





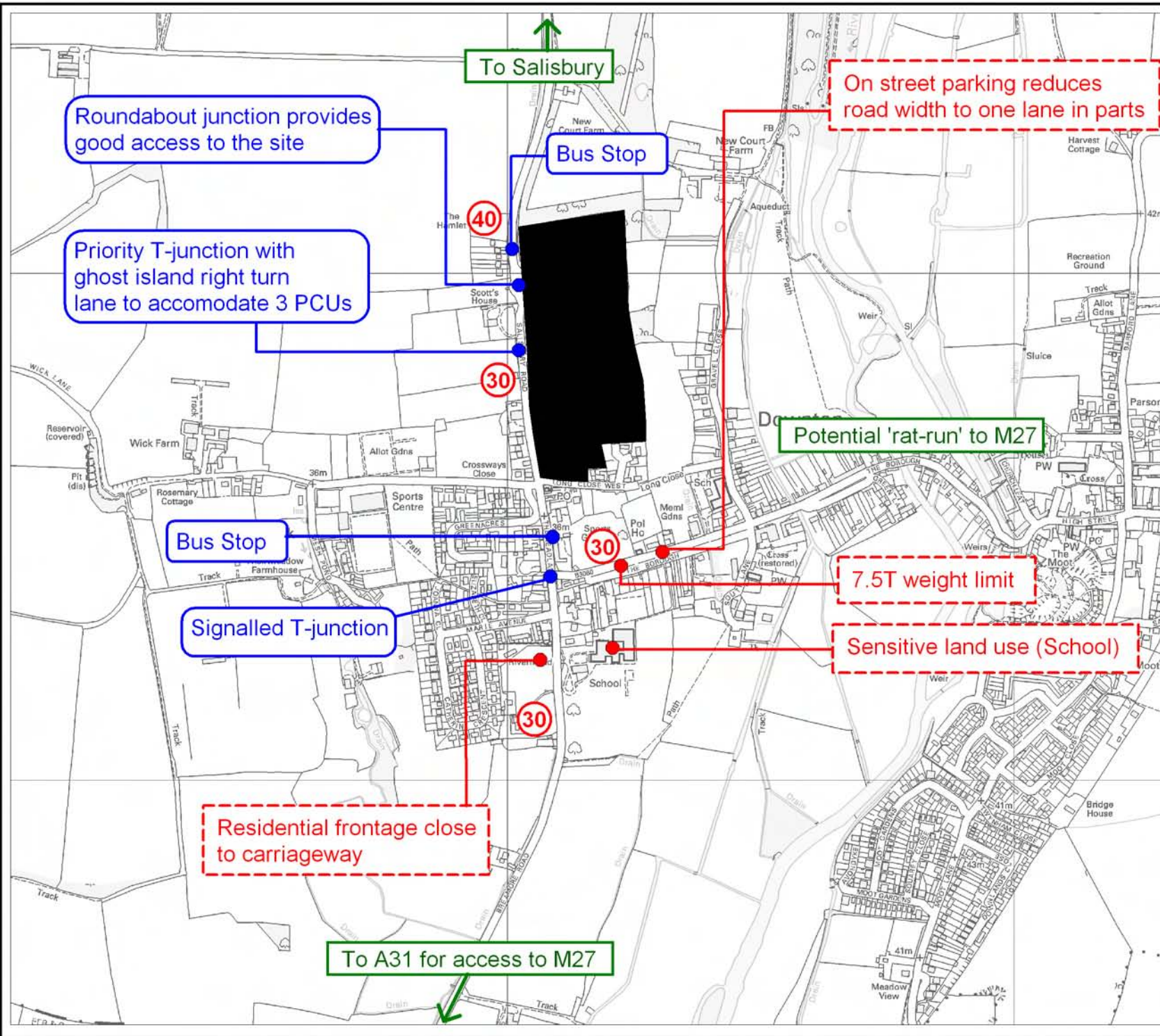

**Key**

- Site
- Information
- Constraint
- ⓪ Speed limit

Project:  
**Wiltshire and Swindon Waste Site Allocations DPD: Detailed Site Assessments**

Drawing Title:  
**S7 - Salisbury Road Industrial Estate, Downton**

Drawing No:  
**5044619.017/TP/S7/001**





**D.3.5 Brickworth Quarry and Landfill (Site Ref S8)  
Site Assessment**



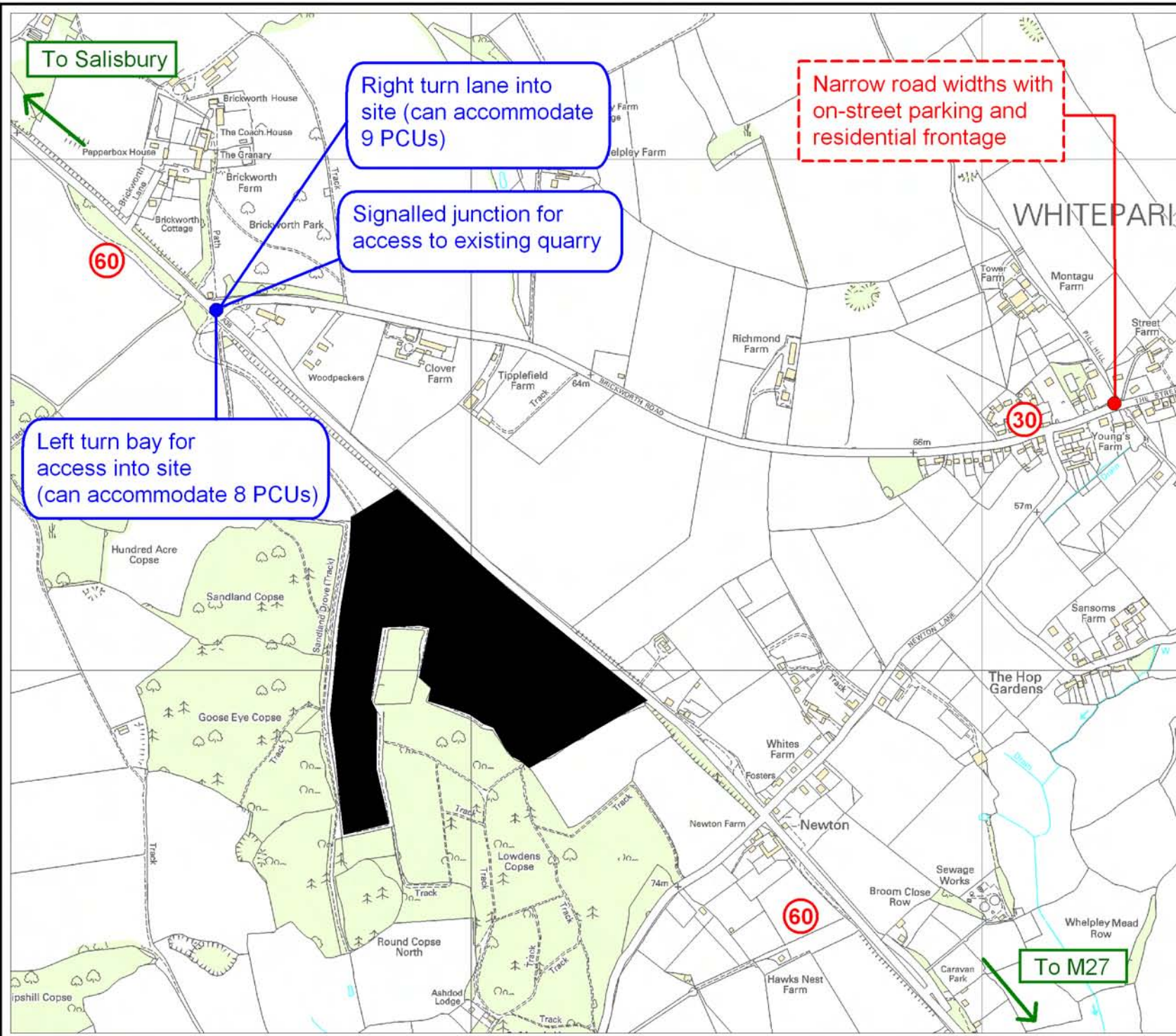

**Key**

- Site
- Information
- Constraint
- ⓪ Speed limit

Project:  
**Wiltshire and Swindon Waste Site Allocations DPD: Detailed Site Assessments**

Drawing Title:  
**S8 - Brickworth Quarry and Landfill**

Drawing No:  
**5044619.017/TP/S8/001**





**D.3.6 Employment Allocation, Mere (Site Ref S9)**  
**Site Assessment**  
**Access Diagram**





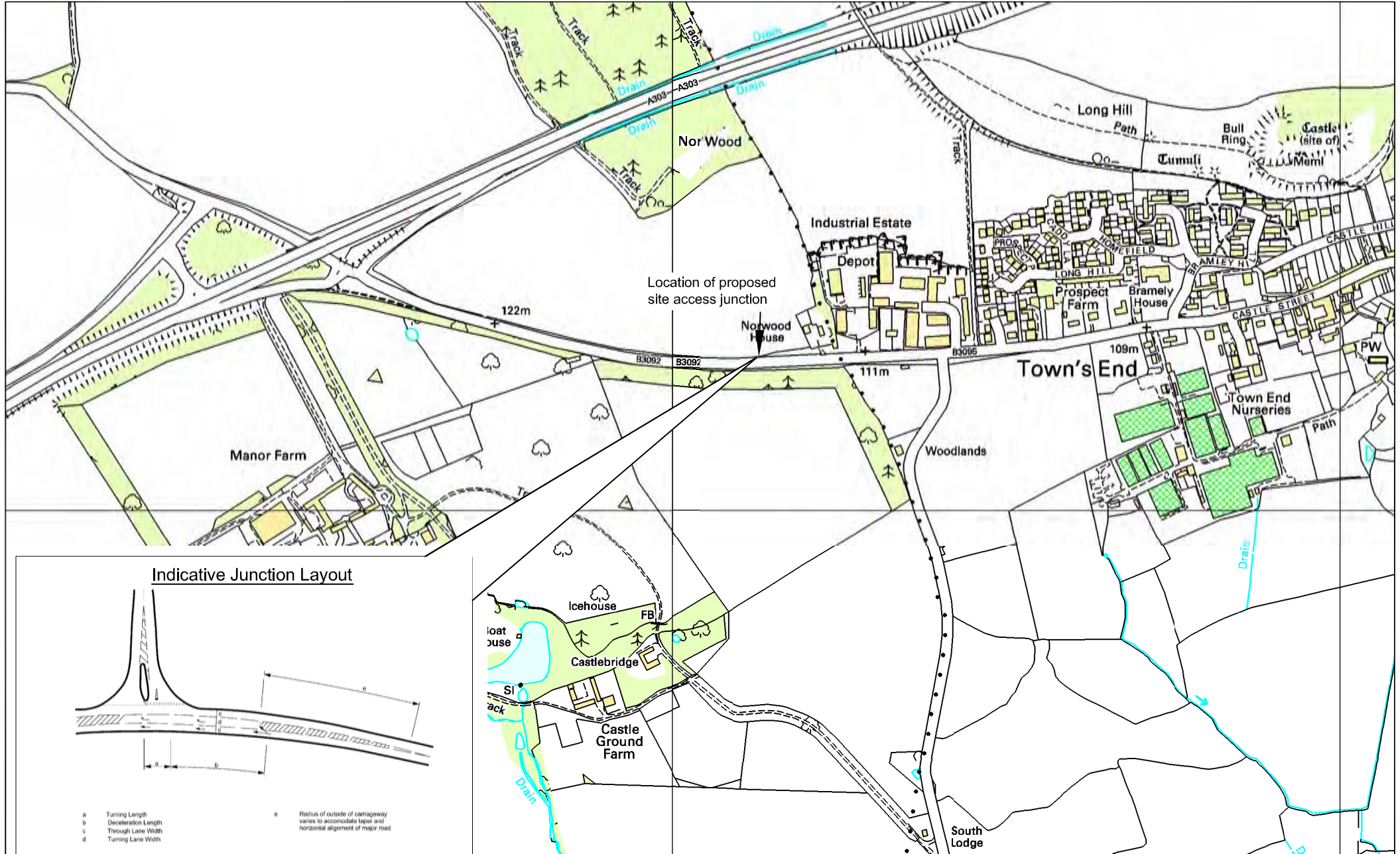



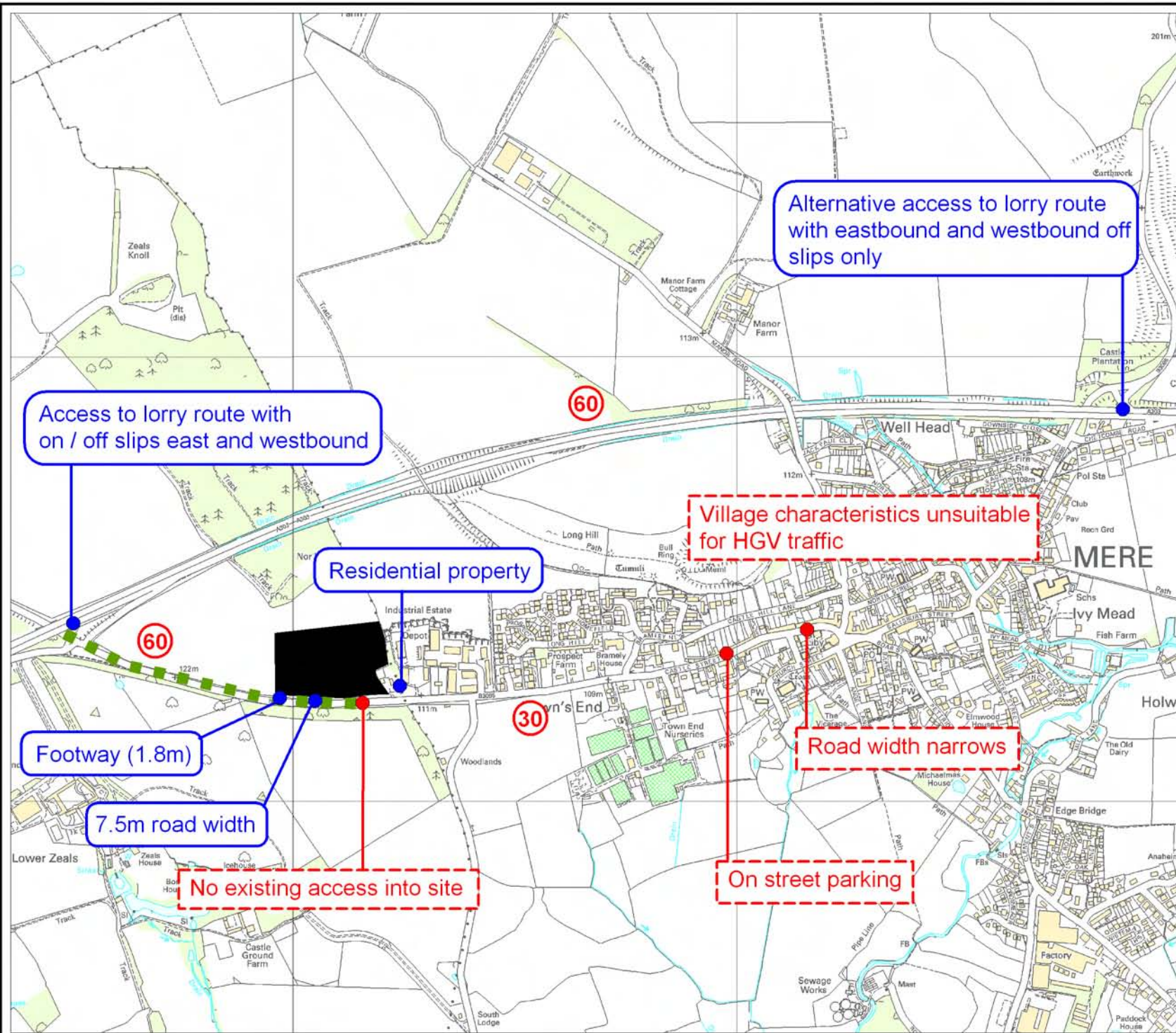

**Key**

- Site
- Information
- Constraint
- ⓪ 40 Speed limit
- Recommended access to strategic HGV network

Project:  
 Wiltshire and Swindon Waste Site Allocations DPD: Detailed Site Assessments

Drawing Title:  
 S9 - Employment Allocation, Mere

Drawing No:  
 5044619.017/TP/S9/001





**D.3.7 Former Imerys Quarry, Quidhampton (Site Ref S10)**  
**Site Assessment**  
**Accessibility Map**



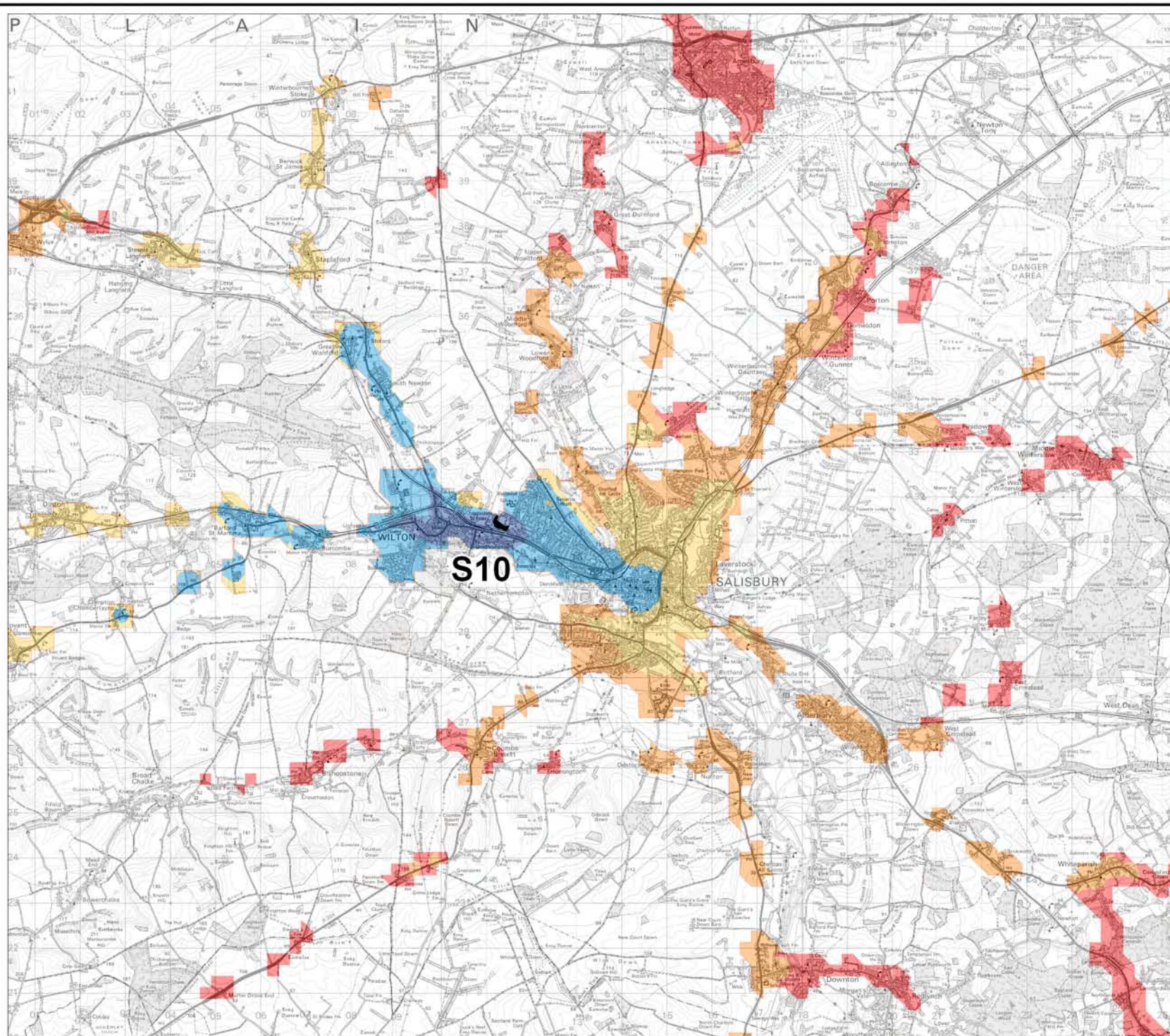

**Key**  
*Direct Bus Accessibility*

- <10minutes
- 10-20minutes
- 20-30minutes
- 30-45minutes
- 45-60minutes
- >60minutes
- Site

*Project:*  
**Wiltshire and Swindon Waste Site Allocations DPD: Detailed Site Assessments**

*Drawing Title:*  
**S10 - Direct Bus Accessibility**

*Drawing No.:*  
**5044619.017/TP/S10/003**



© Crown copyright 2010. All rights reserved.  
 Licence number 0100049050





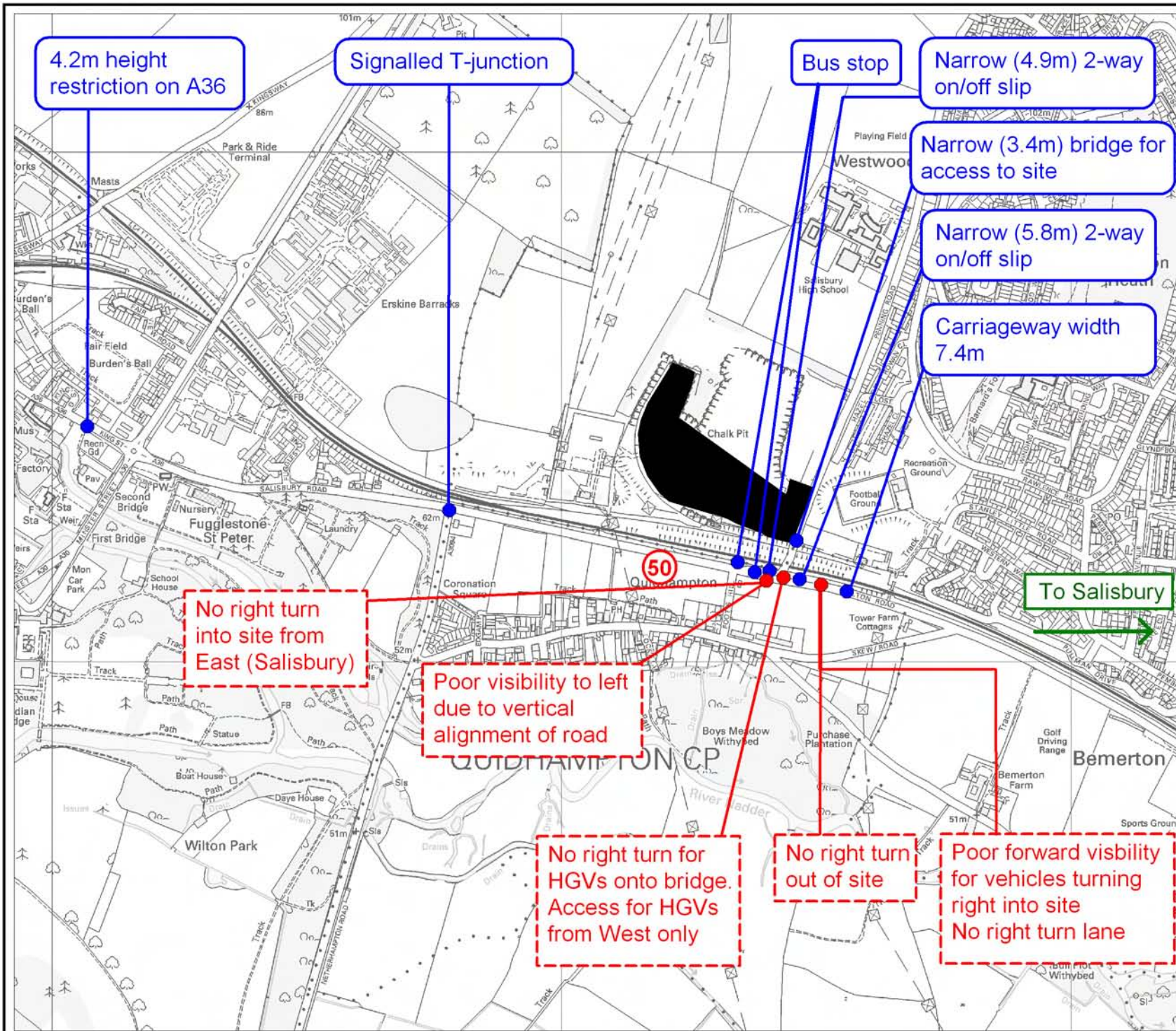

4.2m height restriction on A36

Signalled T-junction

Bus stop

Narrow (4.9m) 2-way on/off slip

Narrow (3.4m) bridge for access to site

Narrow (5.8m) 2-way on/off slip

Carriageway width 7.4m

No right turn into site from East (Salisbury)

Poor visibility to left due to vertical alignment of road

No right turn for HGVs onto bridge. Access for HGVs from West only

No right turn out of site

Poor forward visibility for vehicles turning right into site  
No right turn lane

To Salisbury

**Key**

- Site
- Information
- Constraint
- ⓪ 40 Speed limit

Project:  
Wiltshire and Swindon Waste Site Allocations DPD: Detailed Site Assessments

Drawing Title:  
S10 - Former Imerys Quarry, Quidhampton

Drawing No:  
5044619.017/TP/S10/001



© Crown copyright 2010. All rights reserved.  
Licence number 0100049050

