

PUBLIC INSPECTION COPY
S/03/2547

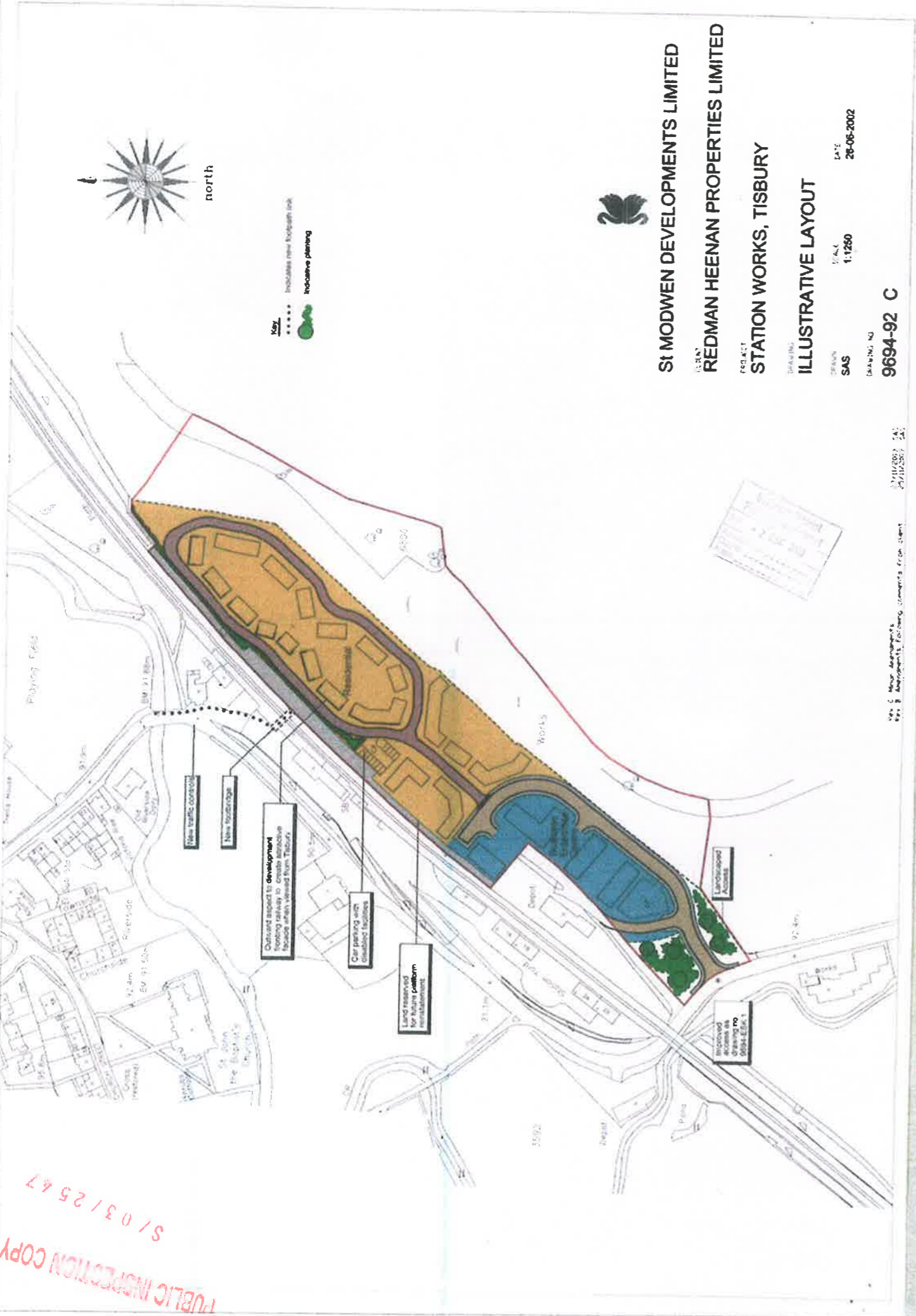

ST MODWEN DEVELOPMENTS LIMITED
REDMAN HEENAN PROPERTIES LIMITED
PROJECT
STATION WORKS, TISBURY

DRAWING
ILLUSTRATIVE LAYOUT

DESIGNER
SAS
SCALE
1:1250
DATE
26-06-2002

DATE
9694-92 C

Mr C. Map Management, Tisbury comments from client
Mr B. Management, Tisbury comments from client

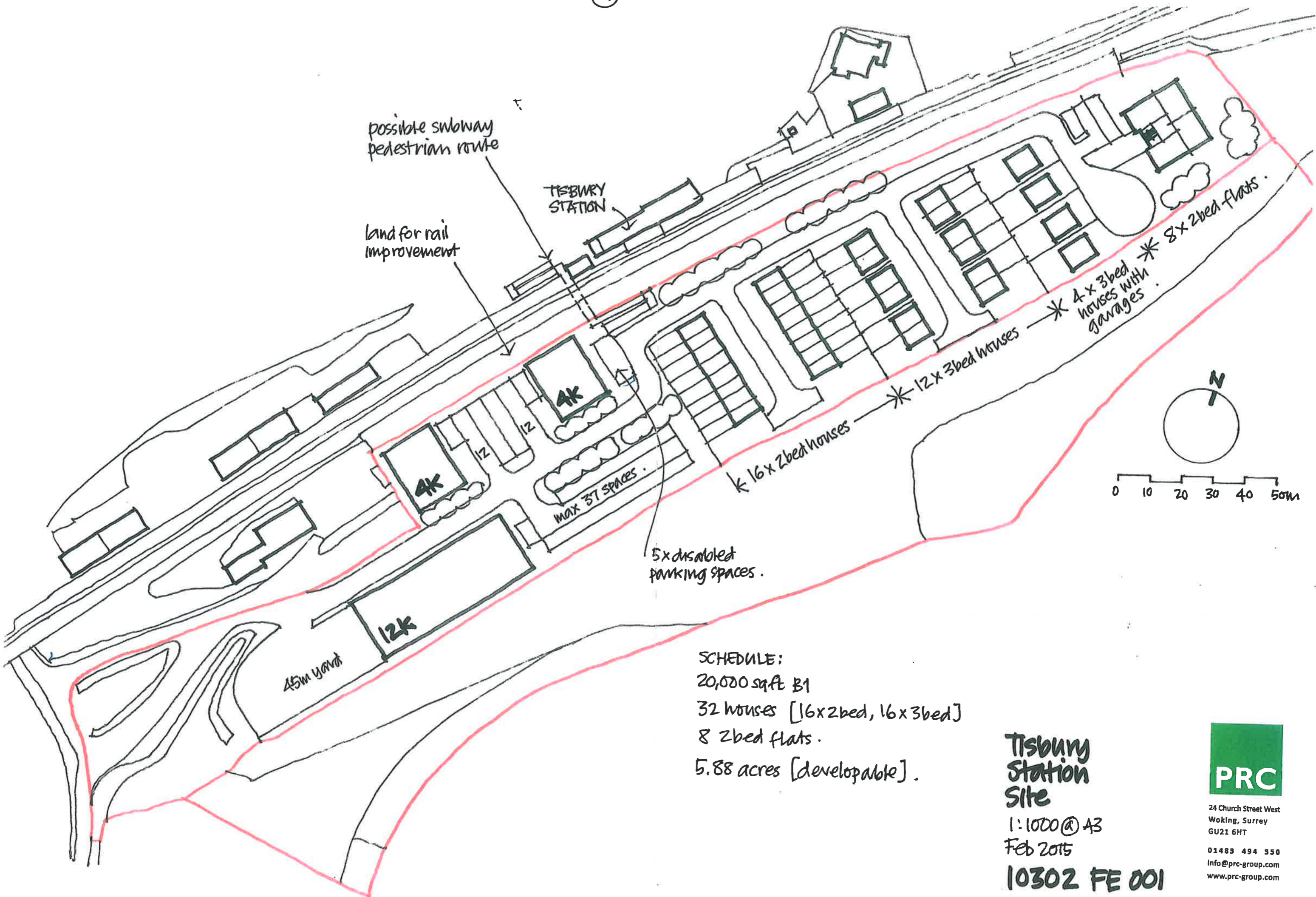

SCHEDULE:
 20,000 sqft B1
 32 houses [16x 2bed, 16x 3bed]
 8 2bed flats.
 5.88 acres [developable].

Tisbury Station Site
 1:1000 @ A3
 Feb 2015
10302 FE 001



24 Church Street West
 Woking, Surrey
 GU21 6HT
 01483 494 350
 info@prc-group.com
 www.prc-group.com